

## Q&A

**Q. Why is the school board addressing these improvements now with the current economic conditions?**

**A.** There are several reasons. The primary reason is our current facilities do not meet the academic needs of our students. With respect to the economy, interest rates for municipal bonds are near record lows, but heading upward. Putting off these improvements will cost taxpayers more in the future. The school board is committed to sound economic practices, and these improvements must happen at some point. In addition, under the current school finance formula, the State of Kansas will pay 37% of the principal and interest on the bonds.

**Q. What are the likely consequences if the bond issue is defeated?**

**A.** Funds would not be available to address facility and educational deficiencies. Students would continue to receive instruction in overcrowded schools and in trailers district wide. Instructional strategies used in smaller learning communities to address truancy, dropout rate and student achievement would not be fully implemented at the high school. Driven by a great deal of community input, the Board of Education is committed to solving the facility and educational concerns. A delay in addressing these issues results in higher construction costs and possibly increased interest rates.

*Quality Learning - Responsible Citizens*



*It's About Our Kids,  
Our Schools and Our Future*

November 4, 2008  
Bond Referendum



## Garden City Public Schools Bond Cost

New High School	\$92,452,224
New Central Early Childhood Center	\$ 3,905,500
Remodel Current High School	\$ 267,500
Remodel Abe Hubert Middle School	\$ <u>802,500</u>
<b>TOTAL</b>	<b>\$97,427,724</b>

## MILL LEVY COMPARISON TO OTHER SCHOOL DISTRICTS

District	Current Mill Levy	With Bond
Dodge City	55.30	Still lower than 3 of 4 nearby districts
Hays	49.65	
Great Bend	46.07	
Liberal	40.01	
Garden City	36.14	45.7

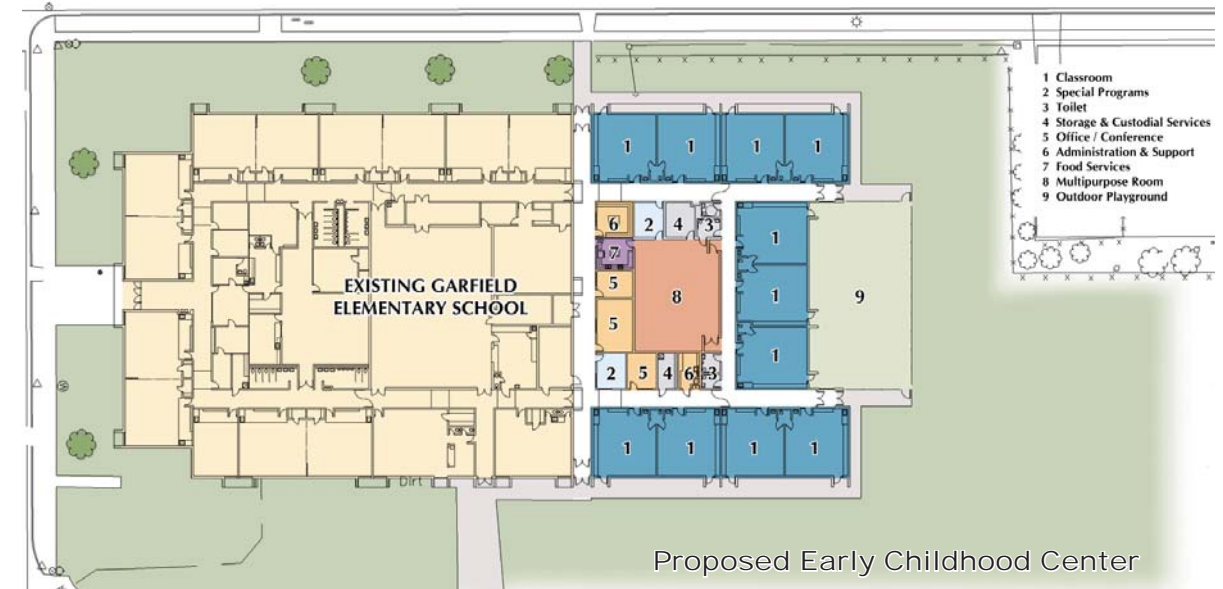

Proposed Early Childhood Center

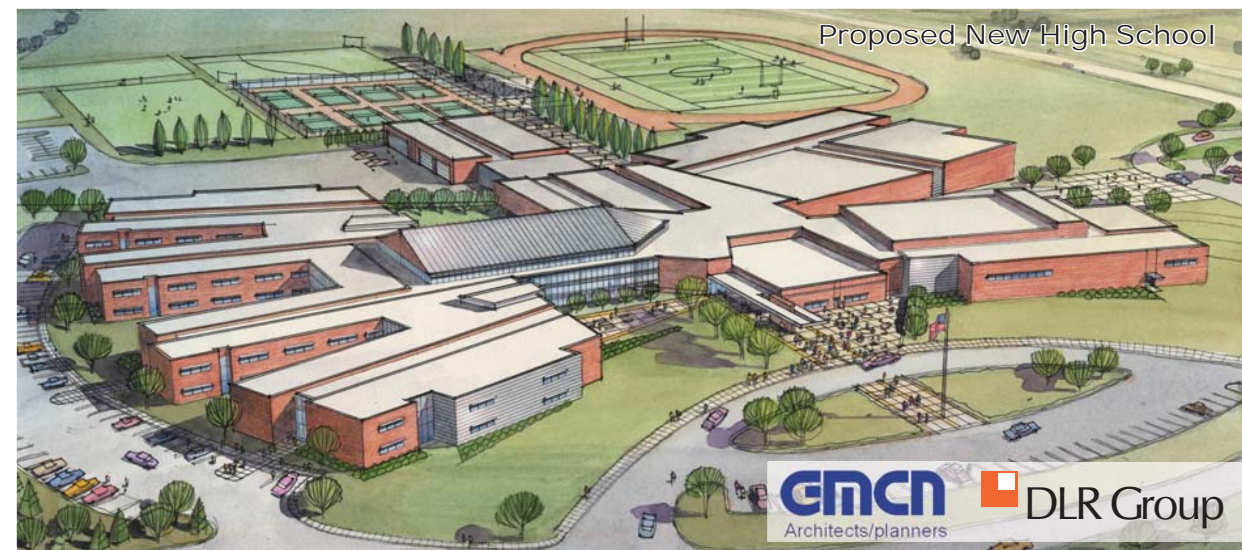

Proposed New High School

## Election Info

Oct. 15 - Advance Voting Begins  
Oct. 20 - LAST DAY to Register to Vote  
Nov. 4 - ELECTION DAY

## Contact Info

**Rick Atha, Superintendent**  
620-805-7010 • ratha@gckschools.com

[www.gckschools.com](http://www.gckschools.com)

Prepared and paid for by Garden City Public Schools to educate patrons about the November 4, 2008 referendum.

**EMCN** Architects/planners  
**DLR Group**

# Issues

A community-based committee studied the following challenges in our District:

- District facilities are overcrowded at all levels
- District is currently using trailers to house 26 classrooms
- Class sizes are larger than optimal for quality education
- Some teachers travel from classroom to classroom which negatively affects teacher preparation, classroom environment and access to instructional resources
- We must continue to provide 21st Century technology opportunities

# Proposed Long-term Solution

All new and remodeled facilities will maintain the welcoming and progressive Garden City atmosphere

## THE SOLUTION:

- Build a new high school at a proposed location north of Mary Street and east of Campus Drive
  - Remodel Garfield Elementary School to be used as a centralized early childhood center
  - Remodel the current high school to use as a middle school
  - Remodel Abe Hubert Middle School to use as Garfield Elementary School
- Building a New High School and Remodeling other District Facilities to Improve the Learning Environment for ALL Students will:
- Provide opportunities for our students to learn in a modern educational environment
  - Provide a smaller learning community instructional environment at the high school
  - Eliminate district-wide use of trailer classrooms
  - Give the district the opportunity to reduce class sizes at all schools by opening up 26 to 30 elementary classrooms and adding 11 early childhood classrooms
  - Increase safety and security by controlling school access
  - Create a centralized early childhood center that allows increased opportunities for students and enhanced involvement of parents
  - Provide continuity of instruction across pre-kindergarten programs to prepare all students equally for kindergarten
  - Enhance career and technical education programs

# What will it cost?

The bond referendum is for \$97.5 million. The mill rate would increase by 8.42 mills, which added to the existing bond rate of 1.14 mills, will equal **9.56** mills. The monthly tax impact on a \$100,000 home would be **\$9.16**.

Value of Home	Monthly Expenses	Yearly Expenses
\$ 75,000	\$ 6.87	\$ 82.46
\$100,000	\$ 9.16	\$109.94
\$150,000	\$13.75	\$164.91
\$200,000	\$18.32	\$219.88
\$300,000	\$27.49	\$329.82

\* The total estimated mill levy of **9.56** mills reflects the current State of Kansas contribution of 37 cents on the dollar to retire bonds. The bonds will be retired over a 25-year payback.

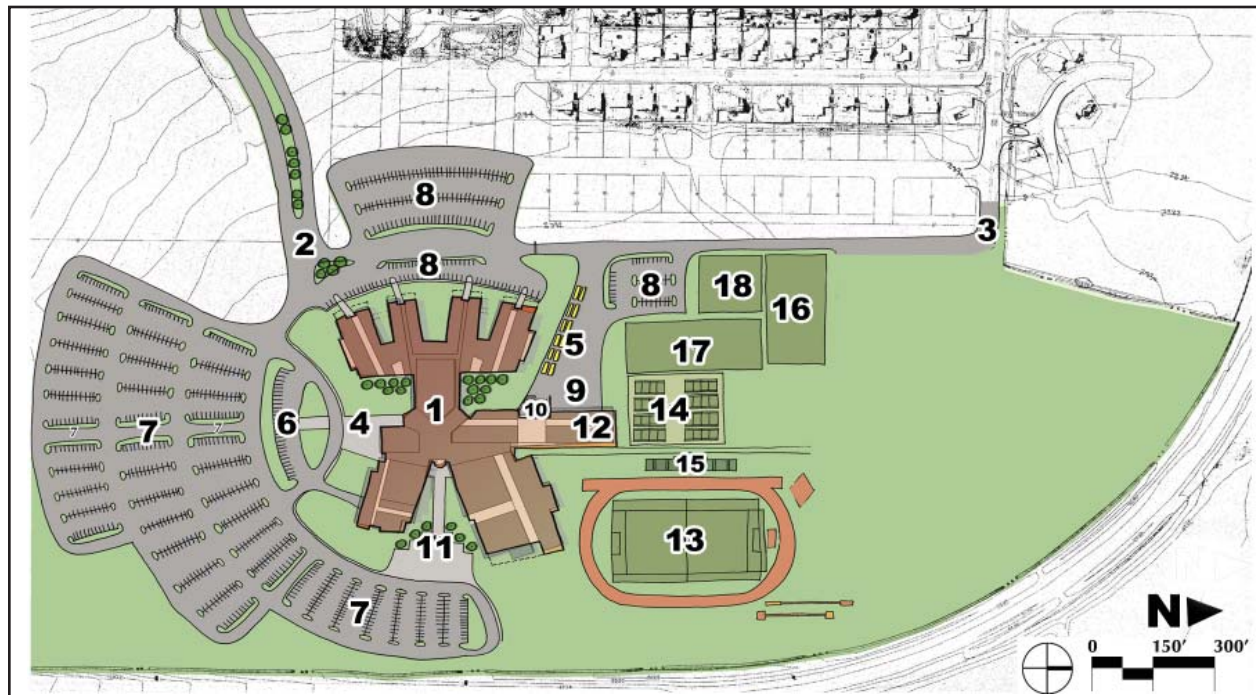

## Proposed New High School SITE PLAN

1. New High School
2. New Approach & Drive
3. Bus & Service Drive- Gated
4. Vehicular Loop
5. Bus Loop
6. Visitor Parking
7. Student Parking
8. Staff Parking
9. Service Road
10. Dock & Trash Enclosure
11. Main Entrance Plaza
12. Storage
13. Practice Football/Soccer/ Track & Field
14. Tennis Courts
15. Bleachers
16. Practice Soccer Field
17. Practice Football Field
18. Agricultural Field

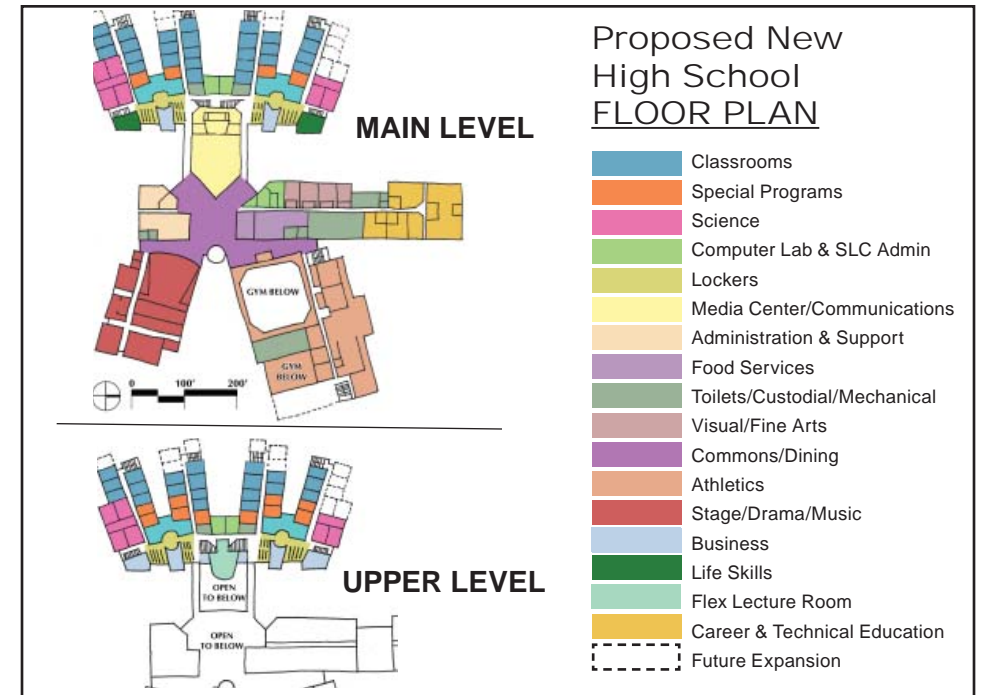

## Proposed New High School FLOOR PLAN

- Classrooms
- Special Programs
- Science
- Computer Lab & SLC Admin
- Lockers
- Media Center/Communications
- Administration & Support
- Food Services
- Toilets/Custodial/Mechanical
- Visual/Fine Arts
- Commons/Dining
- Athletics
- Stage/Drama/Music
- Business
- Life Skills
- Flex Lecture Room
- Career & Technical Education
- Future Expansion